

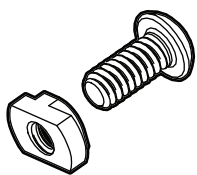

M-LOK™ T-NUT REPLACEMENT SET



- ⚠ **WARNING:** BEFORE STARTING, MAKE SURE THE WEAPON IS UNLOADED, THE CHAMBER IS EMPTY, AND THE SAFETY ENGAGED.
- ⚠ **CAUTION:** PLEASE READ ALL INSTRUCTIONS BEFORE PROCEEDING. COMPONENTS UNDER SPRING PRESSURE MAY EJECT FORCEFULLY AND COULD CAUSE INJURY.
- ⚠ **WARNING:** OBSERVE SAFE FIREARM HANDLING PRACTICES AT ALL TIMES. FAILURE TO DO SO MAY RESULT IN SERIOUS BODILY INJURY OR DEATH. MAGPUL INDUSTRIES SHALL NOT BE RESPONSIBLE FOR INJURY, DEATH OR PROPERTY DAMAGE RESULTING FROM FAULTY INSTALLATION, MISUSE, ILLEGAL USE, OR MODIFICATION OF THIS PRODUCT.

INSTALLATION INSTRUCTIONS

STEP 1

Install *T-Nuts* and *Screws* to the rail segment or accessory. Insert the *Screws* through the top of the accessory and thread on the *T-Nuts* with the "stem" of the nut facing up. Initial installation may be stiff due to the nylon thread patch on the *Screws*.

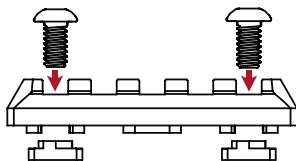

STEP 2

Adjust the *T-Nuts* for mounting surface thickness. The distance between the bottom of the accessory (not the lug) and the top "flat" of the *T-Nut* should be just wider than mounting surface thickness.

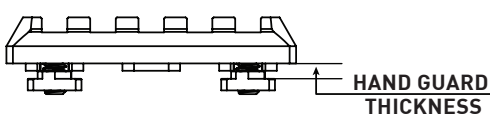

STEP 3

Choose a mounting location. Your *M-LOK* accessory can be adjusted in 20mm increments (1/2 slot length).

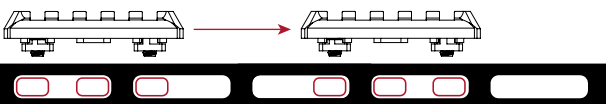

STEP 4

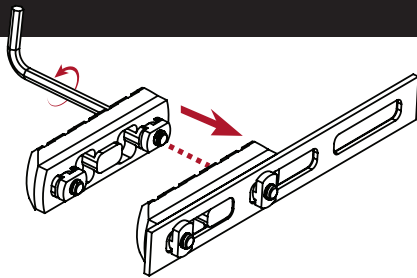

Align the *T-Nuts* and Insert the accessory. Rotate *T-Nuts* inline with the slot and insert the *lugs/t-nuts* into the slot in the desired location.

STEP 5

Tighten Screws. Using a 1/8" hex wrench in the screw head, push down to fully seat the *Screw* in the accessory, then turn clockwise to tighten. The *T-Nut* should rotate 90 degrees across the slot and stop rotating, tightening down as you continue to turn. Visually confirm that the nuts are rotated, if possible. Continue tightening until accessory is secure, but do not exceed maximum torque values. Exceeding torque values may damage mounting surface.



INSTALL/UNINSTALL

TIGHTEN

T-NUT LOCKED

Maximum Installation Torque:

Metal accessories to metal hand guards: 35 in/lbs

Polymer or metal accessories to polymer hand guards: 15 in/lbs

Polymer accessories to metal hand guards: 15 in/lbs

REMOVAL

To remove, simply loosen the accessory mounting screws one full turn and the *T-Nuts* should loosen and align with the slot to be easily removed.

On some polymer mounting surfaces, the *T-Nuts* may embed slightly into the polymer surface when tightened. When removing from polymer surfaces, easiest function is obtained by loosening 1/2 turn or so and then pressing down on the head of the hex wrench. This will free the *T-Nut* if it has been over tightened, and you may remove normally after this step.