

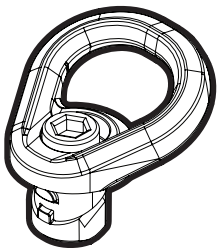

QD Paraclip™ Adapter



- ⚠ **WARNING:** BEFORE STARTING, MAKE SURE THE WEAPON IS UNLOADED, THE CHAMBER IS EMPTY, AND THE SAFETY ENGAGED.
- ⚠ **CAUTION:** PLEASE READ ALL INSTRUCTIONS BEFORE PROCEEDING. COMPONENTS UNDER SPRING PRESSURE MAY EJECT FORCEFULLY AND COULD CAUSE INJURY.
- ⚠ **WARNING:** OBSERVE SAFE FIREARM HANDLING PRACTICES AT ALL TIMES. FAILURE TO DO SO MAY RESULT IN SERIOUS BODILY INJURY OR DEATH. MAGPUL INDUSTRIES SHALL NOT BE RESPONSIBLE FOR INJURY, DEATH OR PROPERTY DAMAGE RESULTING FROM FAULTY INSTALLATION, MISUSE, ILLEGAL USE, OR MODIFICATION OF THIS PRODUCT.

INSTALLATION INSTRUCTIONS

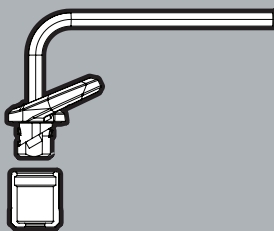

STEP 1

Using a 9/64" hex wrench, make sure the *Paraclip Adapter Clamp Screw* is loosened enough to allow the *Paraclip Adapter Clamp* to slide completely open.

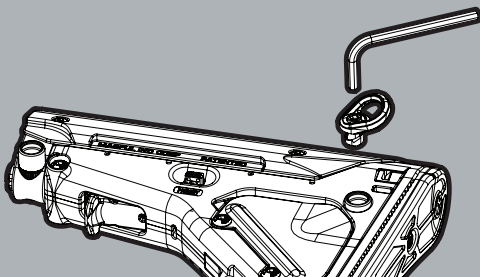

STEP 2

Insert the *Paraclip Adapter* into the *QD socket* and orient the *Paraclip Adapter Loop* to the desired position.

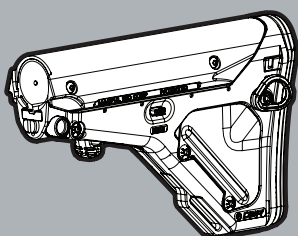
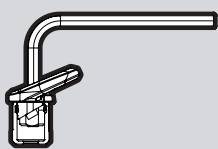

STEP 3

Hand tighten the *Clamp Screw* using a 9/64" hex wrench. Support the *Paraclip Adapter Loop* to prevent it from rotating as the screw is tightened.