

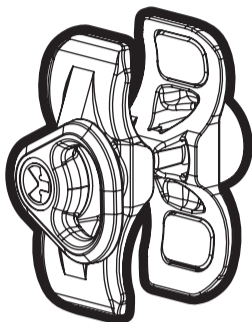

Forward Sling Mount

for Remington® 870, Mossberg® 500/590



- ⚠ WARNING: BEFORE STARTING, MAKE SURE THE WEAPON IS UNLOADED, THE CHAMBER IS EMPTY, AND THE SAFETY ENGAGED.**
- ⚠ CAUTION: PLEASE READ ALL INSTRUCTIONS BEFORE PROCEEDING. COMPONENTS UNDER SPRING PRESSURE MAY EJECT FORCEFULLY AND COULD CAUSE INJURY.**
- ⚠ WARNING: OBSERVE SAFE FIREARM HANDLING PRACTICES AT ALL TIMES. FAILURE TO DO SO MAY RESULT IN SERIOUS BODILY INJURY OR DEATH. MAGPUL INDUSTRIES SHALL NOT BE RESPONSIBLE FOR INJURY, DEATH OR PROPERTY DAMAGE RESULTING FROM FAULTY INSTALLATION, MISUSE, ILLEGAL USE, OR MODIFICATION OF THIS PRODUCT.**

FORWARD SLING MOUNT INSTALLATION

STEP 1: SILICONE PAD APPLICATION

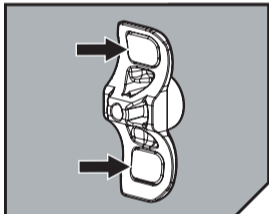

Before installing *Sling Mount*, place *Silicone Pads* into depressions on inside of both *Sling Mount Halves*.

STEP 2: SLING MOUNT INSTALLATION

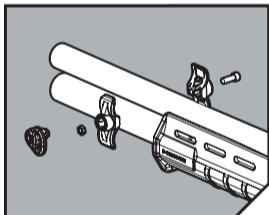

After removing current mount (if applicable), select desired mount location on *magazine extension tube*. Tighten provided screw through *Sling Mount Halves* and either *Sling Loop* or provided *Nut* on opposite side.
⚠ Maximum Torque 25 in-lbs.

Note: Take care not to over-tighten screw. Over tightening may result in damage to the sling mount, magazine extension tube, or barrel.

STEP 3: VERIFY INSTALL

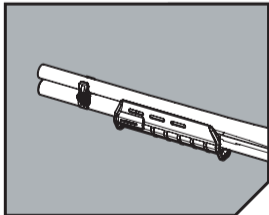

Perform final inspection including function test to verify correct installation. If you experience any issues during installation, please refer to the "Related Info" tab, located on the product page at www.magpul.com.

Note: Always test fire your weapon before using it in an operational environment.

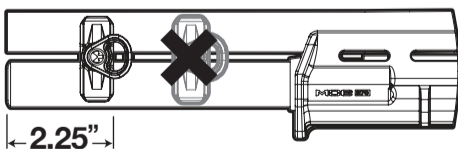

Some models have a longer magazine tube installed at the factory. Before installing in this location ensure that there is enough space for the *Sling Mount* with the fore end fully forward.

For best operation and compatibility, torque to **23 in-lbs** and place sling clamps within **2.25 inches** of the end of the magazine tube or extension.

NOTE: When used with compensated barrels avoid covering any compensation ports with the clamp.