



This item is subject to the Export Administration Regulations (15 CFR §§730-774). A prior authorization from the U.S. Department of Commerce may be required to export, re-export, transfer or re-transfer this item abroad either in its original form or after being incorporated into other end items.



# MOE<sup>®</sup> M-LOK<sup>™</sup> FOREND INSTALLATION INSTRUCTIONS

**! WARNING: BEFORE STARTING, MAKE SURE THE WEAPON IS UNLOADED, THE CHAMBER IS EMPTY, AND THE SAFETY ENGAGED.**

## STEP 1: FOREND PREPARATION

Remove magazine cap, barrel, forend tube castle nut, and forend per manufacturer instructions.

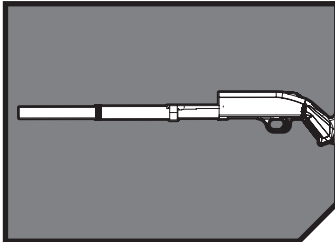

## STEP 2: ALIGN FOREND

Align MOE M-LOK Forend with magazine tube, with the slots and Magpul logo on the Forend away from the receiver and towards the muzzle.

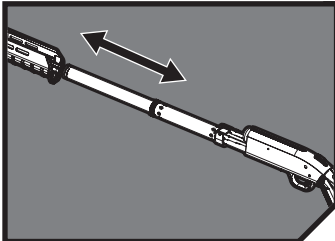

## STEP 3: INSTALL FOREND

Slide the Forend onto the forend tube until the rear of the Forend is seated.

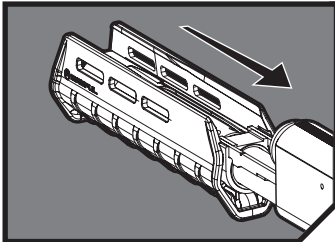

## STEP 4: ANTI-ROTATION INSERT AND CASTLE NUT INSTALL

Install the Anti-Rotation Insert onto the magazine tube and seat into the end of the Forend, flat side toward Forend.

For Mossberg 500 and 590, use Insert 414-0081  
For Mossberg 590A1, use Insert 414-0082

Slide the castle nut over the magazine tube and seat on top of the Anti-Rotation Insert. Using the Castle Nut Wrench, thread the castle nut onto the forend tube and hand tighten.

**Caution: DO NOT OVER TIGHTEN.** Over tightening can cause damage to the Forend or shotgun components.

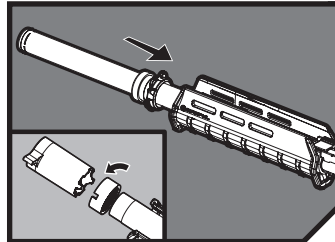

## STEP 5: COMPLETE AND VERIFY INSTALL

Re-install the barrel and magazine cap per manufacturer instructions.

Perform final inspection including function test to verify correct installation. If you experience any issues during installation, please refer to the "Related Info" tab, located on the product page at [www.magpul.com](http://www.magpul.com).

**Note: Always test fire your weapon before using it in an operational environment.**

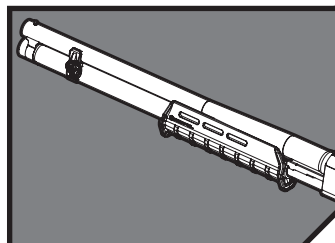

### COMPATIBILITY NOTE:

May require additional parts and gunsmithing for use with Mossberg<sup>®</sup> Maverick, some Mossberg<sup>®</sup> 500 models, or as a replacement for Mossberg<sup>®</sup> Tri-Rails.

MOSSBERG IS A REGISTERED TRADEMARK OF MOSSBERG & SONS, INC.

072-0094-A

WWW.MAGPUL.COM • 1.877.4MAGPUL