

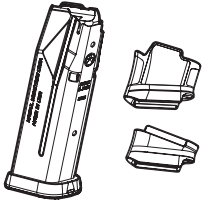

## AMAG® 17/15 SG9 - SIG P365

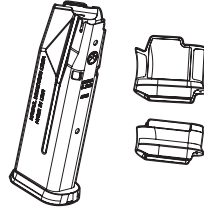

MAGI486 - AMAG® 17 SG9 - SIG P365



MAGI487 - AMAG® 15 SG9 - SIG P365

# INSTALLATION INSTRUCTIONS

READ ALL INSTRUCTIONS BEFORE PROCEEDING TO AVOID LOSING ANY SMALL COMPONENTS

**! STOP: IMPROPER CONFIGURATION, INSTALLATION AND/OR IMPROPER USE OF THIS PRODUCT MAY CAUSE WEAPON MALFUNCTION. WEAPON MALFUNCTION MAY CAUSE SERIOUS INJURY, INCLUDING GRIEVOUS BODILY HARM AND/OR DEATH.**

**! WARNING: BEFORE STARTING, MAKE SURE THE WEAPON IS UNLOADED, THE CHAMBER IS EMPTY, AND THE SAFETY ENGAGED.**

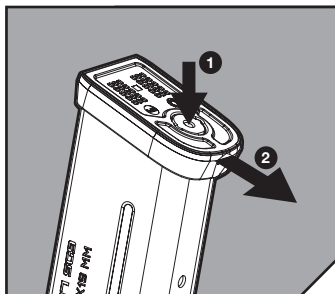

### STEP 1: UNINSTALL EXISTING FLOORPLATE

Turn Magazine upside down. Depress the Lockplate (1) and slide original Floorplate off of the Magazine Body Flanges (2), taking care to maintain positive control of the Lockplate and Magazine Spring. Set Floorplate aside.

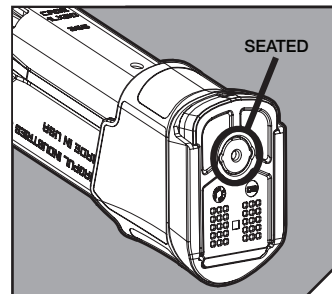

### STEP 4: COMPLETE INSTALLATION

Ensure that the Lockplate is fully seated in the Floorplate. Due to Magazine Spring Tension the Extension Plate may require a light tap to fully seat the Lockplate.

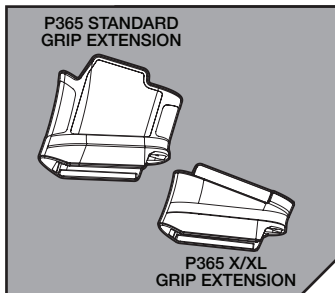

### STEP 2: SELECT AND INSTALL FLOORPLATE/GRIP EXTENSION

The Magpul AMAG for the P365 features user-interchangeable Floorplates and Grip Extensions. Select the preferred Grip Extension based upon the size of the frame on your firearm.

After determining which Floorplate or Grip Extension will be used, slide Grip Extension over the Feedlips of the Magazine Body until it meets the Magazine Body Flanges. There is only one correct orientation of the Grip Extension.

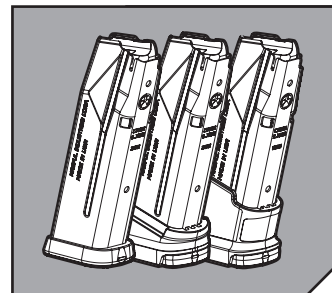

### STEP 5: VERIFY INSTALLATION

**IMPORTANT:** Check function of magazine in host firearm. Ensure Magazine fully seats, drops free, and that the slide locks back on empty.

Perform final inspection including function check per Firearm Owner's Manual.

Always test fire your weapon before using it in an operational environment.

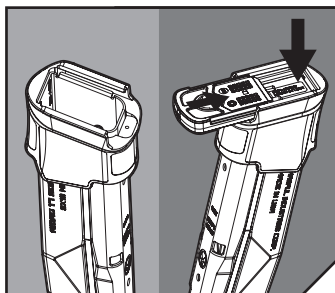

### STEP 3: INSTALL EXTENSION FLOORPLATE

Slightly retract the Grip Extension towards the Feedlips (≈0.060") and depress the Lockplate. Slide the Extension Plate into position, taking care to prevent the Lockplate from tilting up on the spine side of the Magazine Body, as this will prevent installation.